

2021-01-20 4:05:38 PM

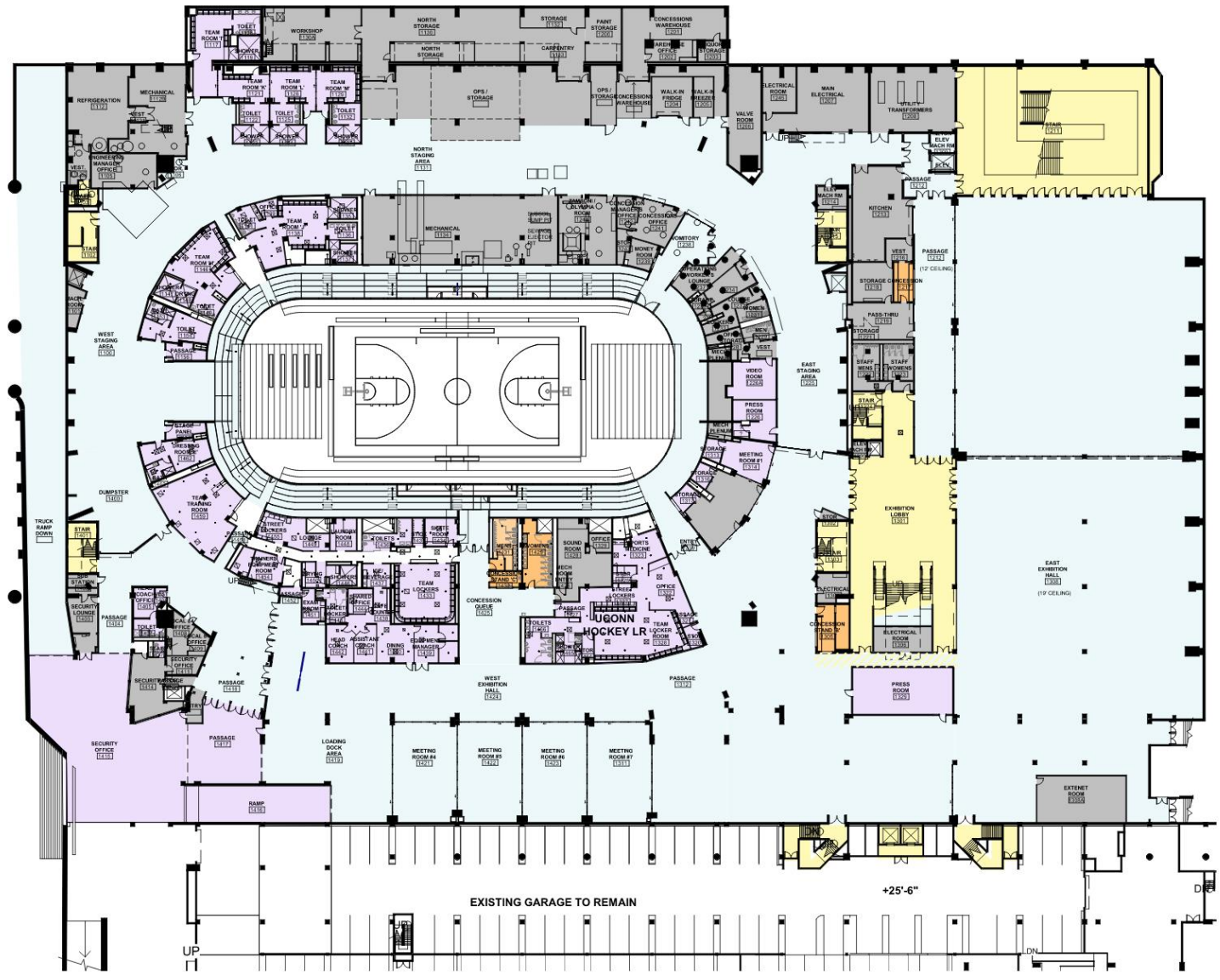

XL CENTER
 1 CIVIC CENTER PLAZA
 HARTFORD, CT 06103
MASTERPLAN
 11,000 SEAT
 CAPACITY

**XL Center – 2022
 Renovation
 Project CM RFP
 Instruction to
 Candidates
 Attachment K -
 SCI Phase 2
 Master Plan**

05/01/20
IN PROGRESS

SCI ARCHITECTS
 0' 10' 25' 50'

**LOWER PLAN
 BASKETBALL**

31B-EXIST

2020-12-11 2:03:15 PM

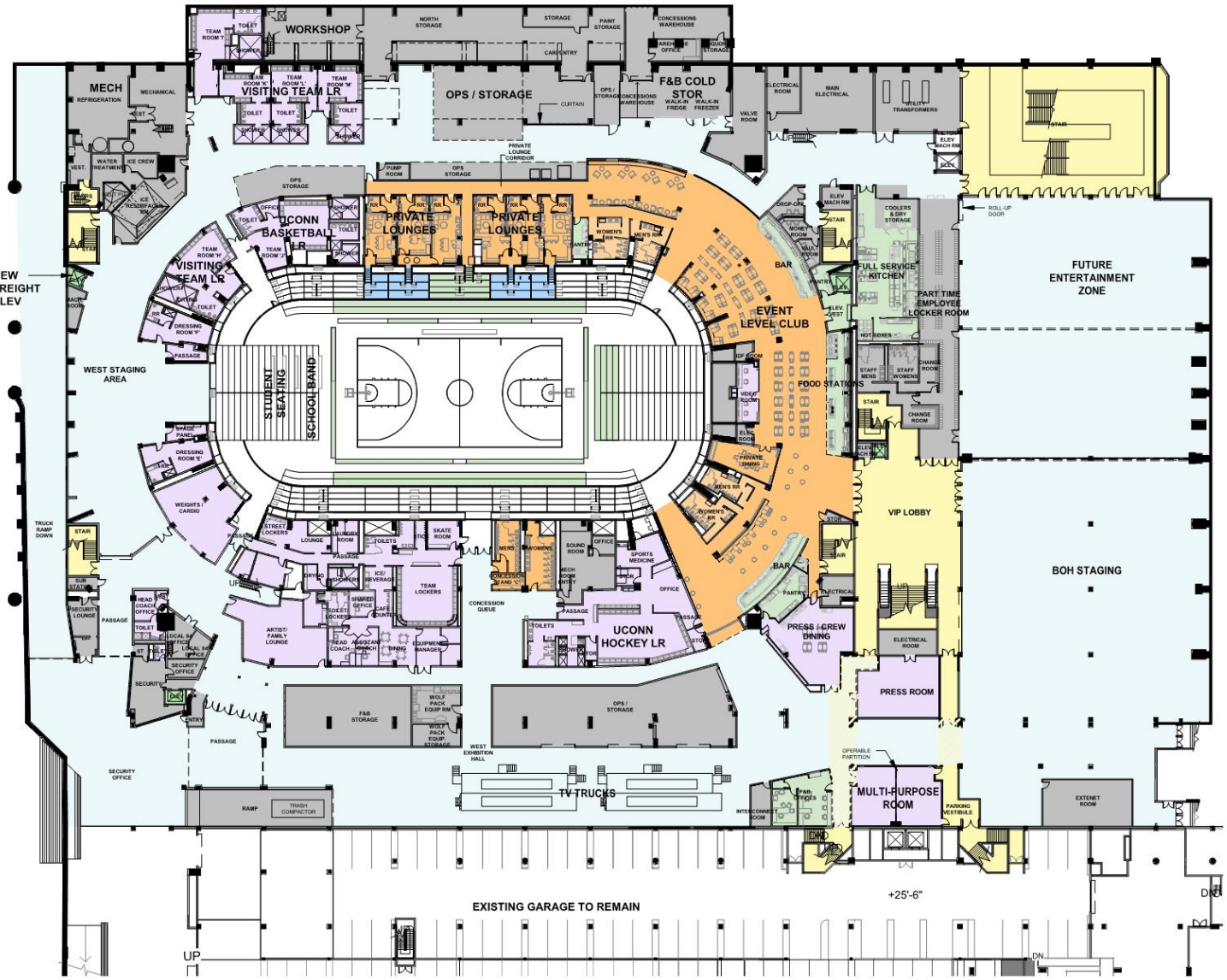

XL CENTER
 1 CIVIC CENTER PLAZA
 HARTFORD, CT 06103
MASTERPLAN
11,000 SEAT
CAPACITY

- RECOMMENDED CSL PREMIUM PRODUCTS**
- EVENT LEVEL CLUB (750 SEATS)
 - PREMIUM SEATING LOUNGE
 - PRIVATE LOUNGES
 - EXECUTIVE SUITES
 - LOGE AND THEATER BOXES
 - LOGE CLUBS
- BASE PROGRAM ELEMENTS**
- NEW OR REFURBISHED VERTICAL CIRCULATION
 - PUBLIC - ENCLOSED AREAS
 - PUBLIC - CIRCULATION
 - BOH / SERVICE
 - BOH CIRCULATION
 - OPEN TO BELOW OR BOWL SEATING
 - EVENT PRODUCTION
 - TENANT

RESTROOM FIXTURE COUNT

EXIST FIXTURES TO REMAIN	
MEN	10
WOMEN	8
L31 EVENT LEVEL CLUB FIXTURES (FOR CLUB CAPACITY 750)	
MEN	8
WOMEN	10

12/09/20
IN PROGRESS



LEVEL 31 MASTERPLAN - BASKETBALL

31B MP

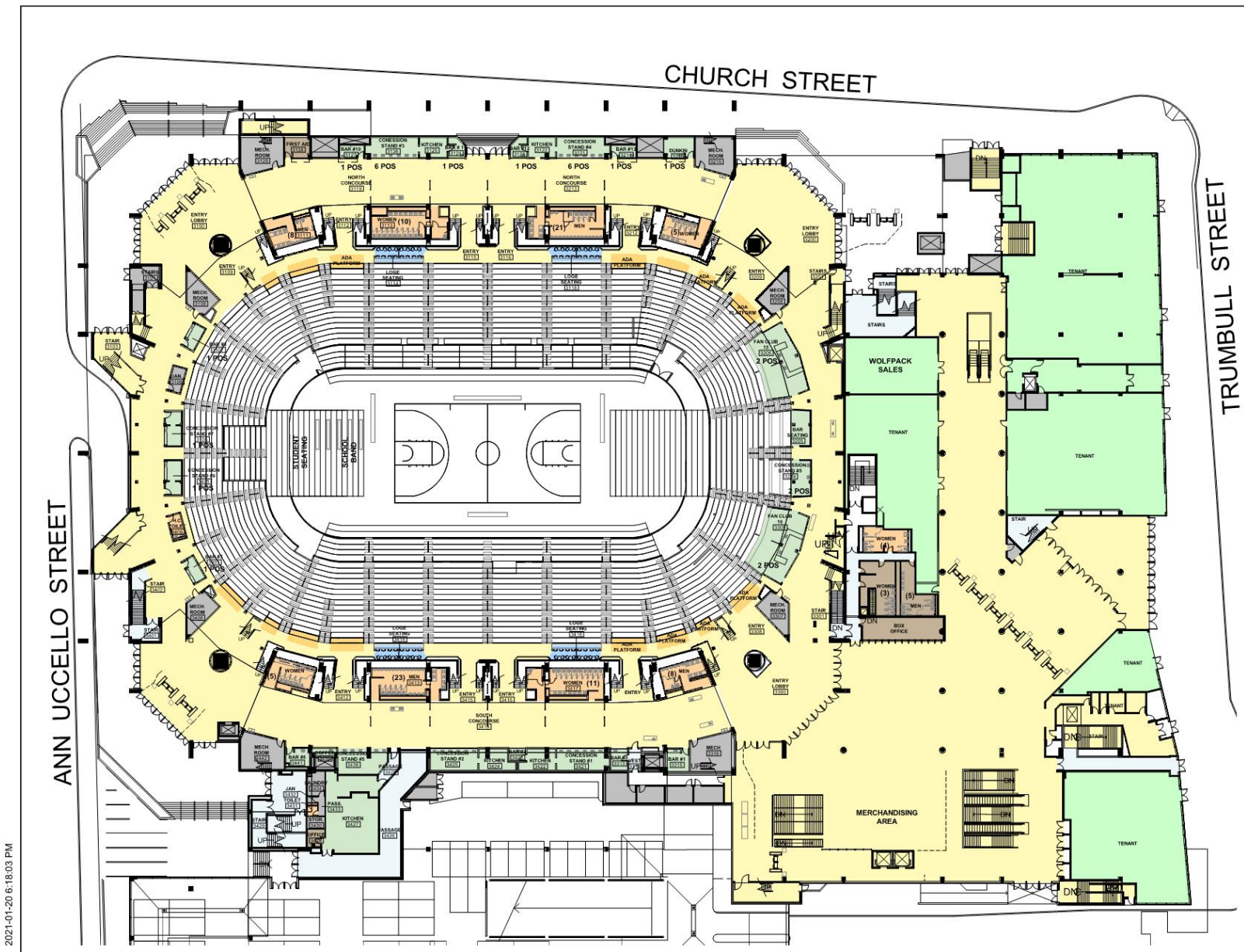

2021-01-20 6:18:03 PM

XL CENTER
 1 CIVIC CENTER PLAZA
 HARTFORD, CT 06103
MASTERPLAN
 11,000 SEAT
 CAPACITY

05/01/20
IN PROGRESS

SC | ARCHITECTS
 0' 10' 25' 50'

MAIN CONCOURSE
 BASKETBALL

61 EXIST

2021-01-20 5:47:48 PM

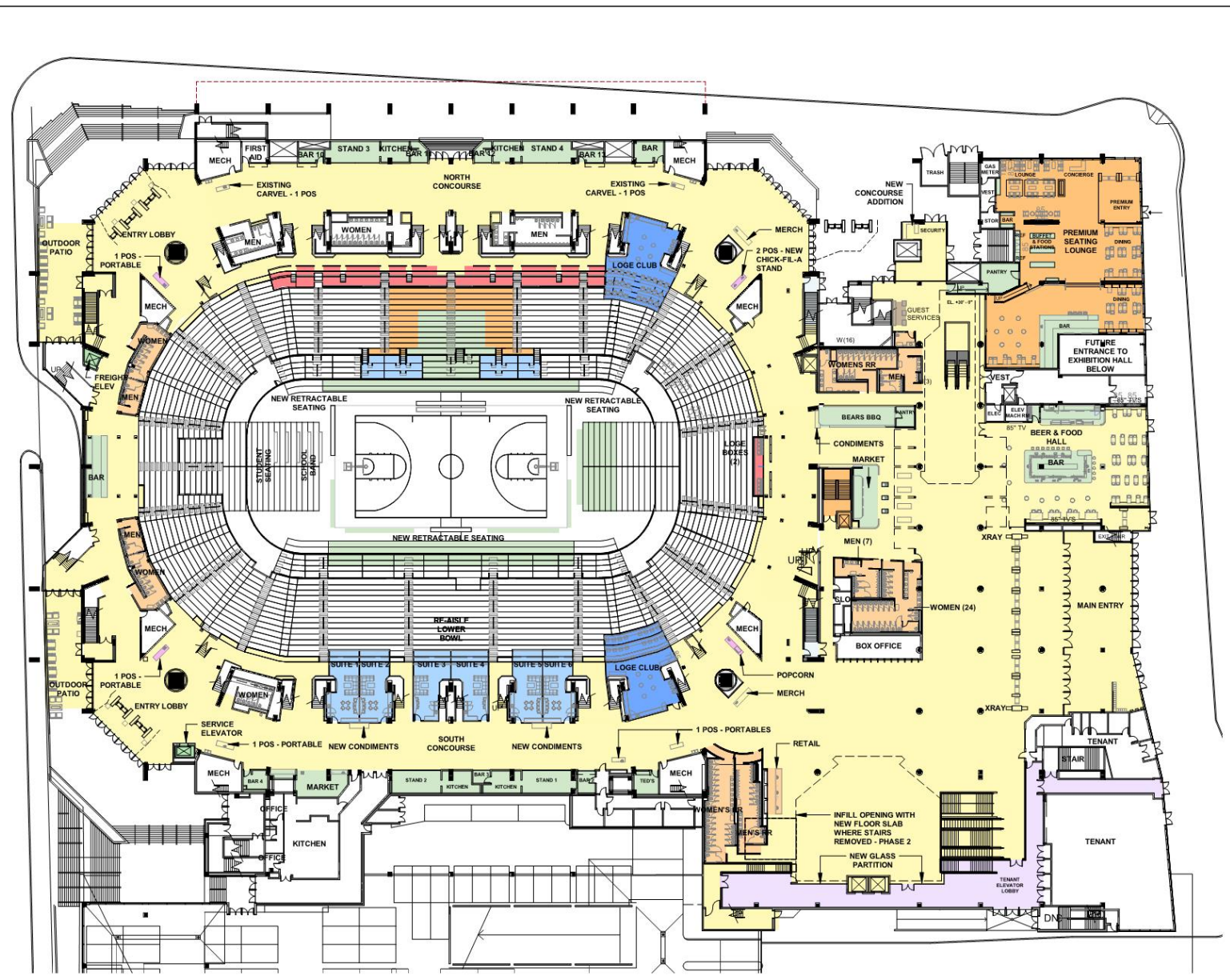

XL CENTER
 1 CIVIC CENTER PLAZA
 HARTFORD, CT 06103
MASTERPLAN
 11,000 SEAT
 CAPACITY

- RECOMMENDED CSL PREMIUM PRODUCTS**
- EVENT LEVEL CLUB (750 SEATS)
 - PREMIUM SEATING LOUNGE & BEER HALL
 - PRIVATE LOUNGES
 - EXECUTIVE SUITES
 - LOGE AND THEATER BOXES
 - LOGE CLUBS
- BASE PROGRAM ELEMENTS**
- NEW OR REFURBISHED VERTICAL CIRCULATION
 - PUBLIC - ENCLOSED AREAS
 - PUBLIC - CIRCULATION
 - BOH / SERVICE
 - BOH CIRCULATION
 - OPEN TO BELOW OR BOWL SEATING
 - EVENT PRODUCTION
 - TENANT
 - NEW PORTABLES

12/18/20
IN PROGRESS

SC | ARCHITECTS
 0' 10' 25' 50'

LEVEL 61 MASTERPLAN - BASKETBALL

61B SCOPE

2021-01-20 4:05:48 PM

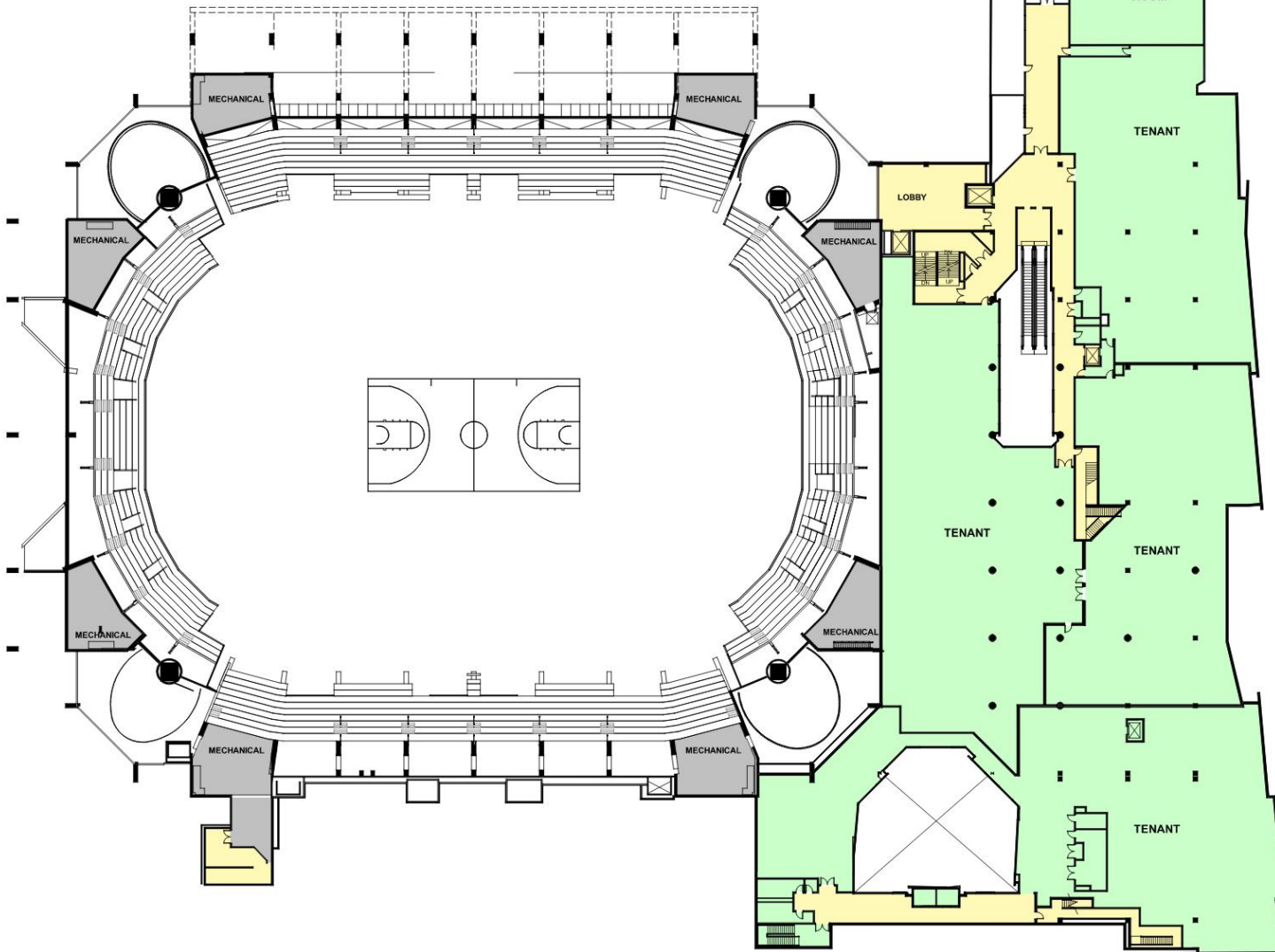

XL CENTER
 1 CIVIC CENTER PLAZA
 HARTFORD, CT 06103
MASTERPLAN
 11,000 SEAT
 CAPACITY

01/20/21
IN PROGRESS

SC | ARCHITECTS
 0' 10' 25' 50'

**NORHLAND TENANT
 PLAN**

80 EXIST

2021-01-20 5:15:55 PM

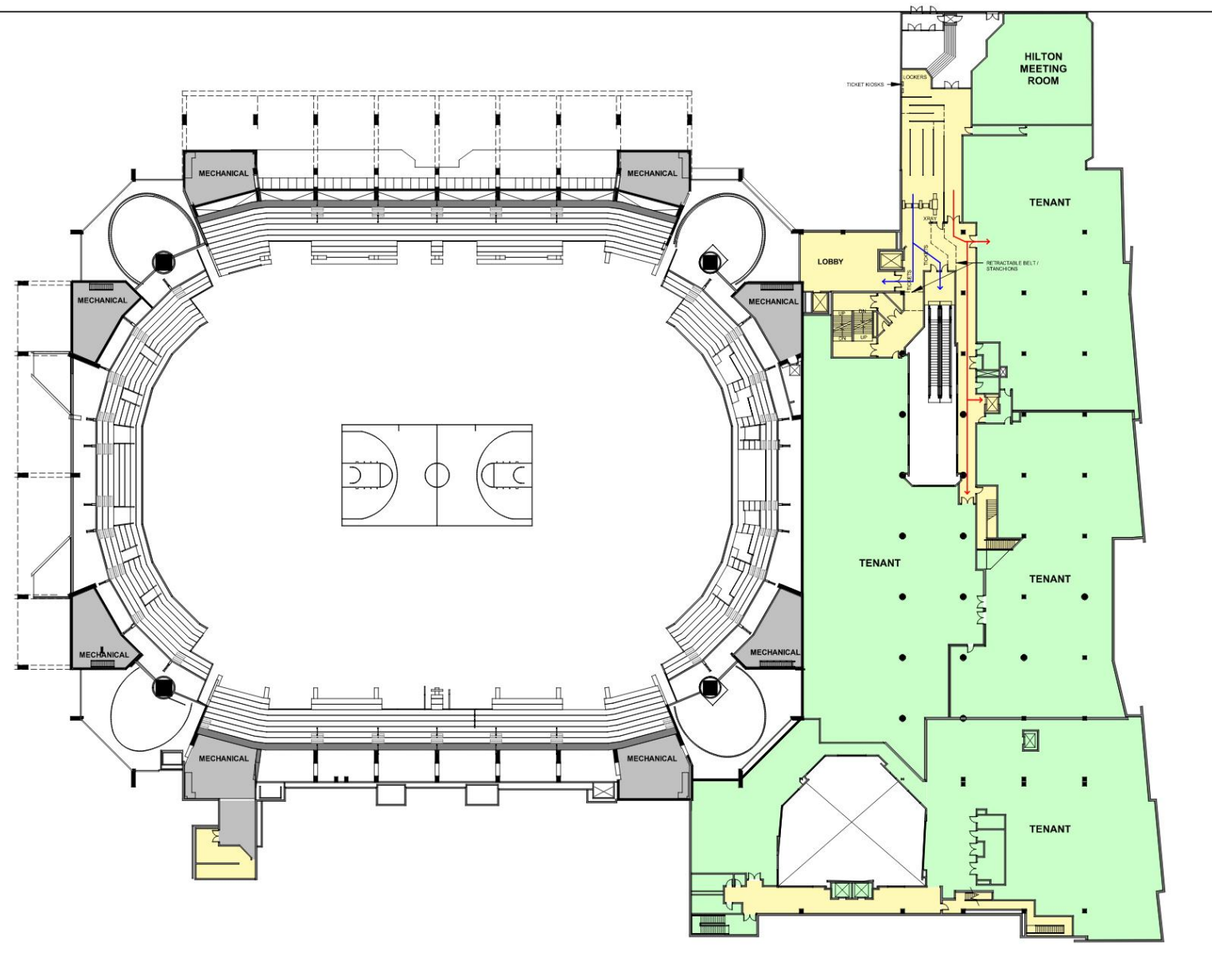

XL CENTER
 1 CIVIC CENTER PLAZA
 HARTFORD, CT 06103
MASTERPLAN
 11,000 SEAT
 CAPACITY

2021/01/18
IN PROGRESS

SC | ARCHITECTS
 0' 10' 25' 50'

**NORHLAND TENANT
 PLAN**

L80 - LOAD-IN